

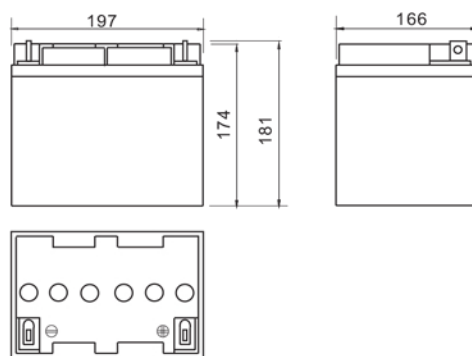

### Outer dimensions (mm)



### Specifications

Nominal Voltage		12V
Rated capacity (10 hour rate)		45Ah
Dimensions	Total Height	181mm (7.13inches)
	Height	174mm (6.85inches)
	Length	197mm (7.73inches)
	Width	166mm (6.54 inches)
Weight Approx		13.5Kg (29.7lbs)

### Terminal Type (mm)

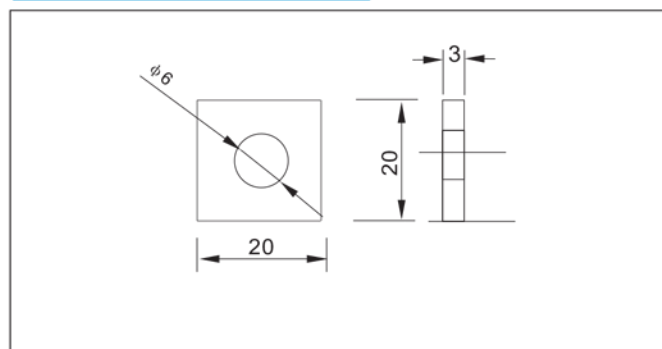

### Characteristics

Capacity 25°C(77°F)	10 hour rate(4.5A)	45.0AH
	5 hour rate(7.2A)	36.0AH
	1 hour rate(27.0A)	27.0AH
	1.5 hour discharge to 10.5V	18A
Internal Resistance	Full charged Battery at 25°C(77°F)	6.5mΩ
Capacity affected by Temperature (10hour rate)	40°C(104°F)	102%
	25°C(77°F)	100%
	0°C(32°F)	85%
	-15°C(5°F)	65%
Self-Discharge at 25°C(77°F)	Capacity after 3 month storage	91%
	Capacity after 6 month storage	82%
	Capacity after 12 month storage	64%
Terminal		T21
Charge (constant Voltage)	Cycle	Initial Charging Current less than 18A Voltage 14.40-14.80V Time 14~16h
	Float	Voltage 13.50-13.80V

### Discharge Curves 25°C(77°F)

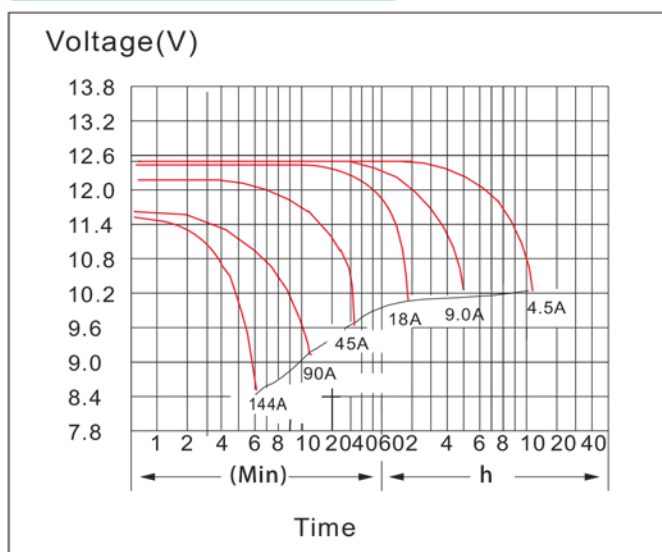

**Constant Current(Amp) and Constant Power(Watt) Discharge Table at 25°C(77°F)**

Time		5min	10min	15min	30min	1h	2h	3h	4h	5h	8h	10h	20h
9.60V	A	144	95	77	51.3	27.0	15.8	11.6	9.0	7.4	5.27	4.73	2.55
	W	1487	1014	821	552	292	173	129	101	84	60	55	29.7
10.20V	A	140	86	72	49.1	25.4	15.0	11.3	8.8	7.3	5.13	4.64	2.48
	W	1491	957	807	551	287	173	130	102	85	60	54	29.0
10.50V	A	135	77	63	45.9	24.6	14.7	11.0	8.6	7.2	5.09	4.55	2.48
	W	1475	872	719	528	285	170	128	101	84	60	54	29.3
10.80V	A	130	72	59	42.3	23.8	14.3	10.7	8.5	7.0	4.95	4.50	2.43
	W	1460	833	675	490	277	168	126	100	83	59	53	28.9
11.10V	A	126	68	54	37.8	23.0	14.0	10.4	8.3	6.8	4.82	4.28	2.30
	W	1426	784	630	442	270	165	123	99	82	58	51.6	27.8